



The
Postal
Museum

VENUE HIRE

at The Postal Museum

WELCOME

The Postal Museum reveals the surprising and fascinating story of the first social network and makes our extraordinary collections available and enjoyable for all.

From interactive galleries to an immersive subterranean rail ride, modern research facilities to a wide-range of learning activities, The Postal Museum offers something for everyone, from all backgrounds and of all ages.

Located in the heart of Central London, our unique event spaces are perfect for any corporate, experiential or private event.

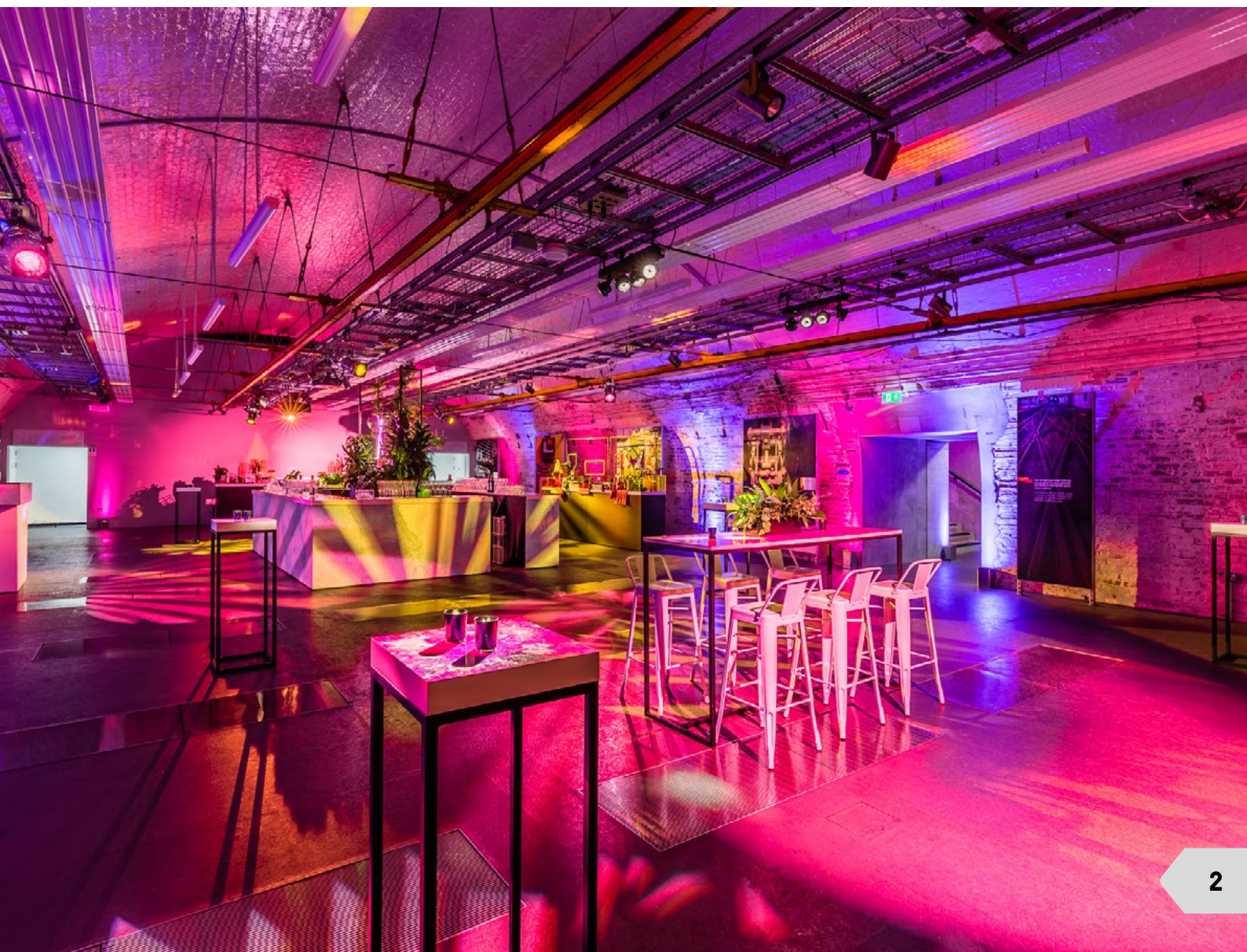

CAPACITIES

We have spaces that can suit a variety of events:

SPACE	EVENT TYPE	CAPACITY
THE COURTYARD	Standing	120
	Seated dinner	60
	Theatre	80
MAIL RAIL	Standing	275
	Seated dinner	150
	Dinner and dance	120
	Theatre	200
MEETING ROOM	Standing	60
	Cabaret	40
	Theatre	50



THE COURTYARD

The Courtyard is a contemporary space that offers access to our fascinating museum Galleries, as well as an intimate courtyard.

Perfect for presentations and networking receptions to summer parties and special occasions, this space features a living wall and original phone box which offers a lively backdrop for events.

With a capacity of 120 standing and 60 seated, this space is available to hire Monday – Friday from 17.00 – 23.00.

From £2,500 + VAT



THE COURTYARD

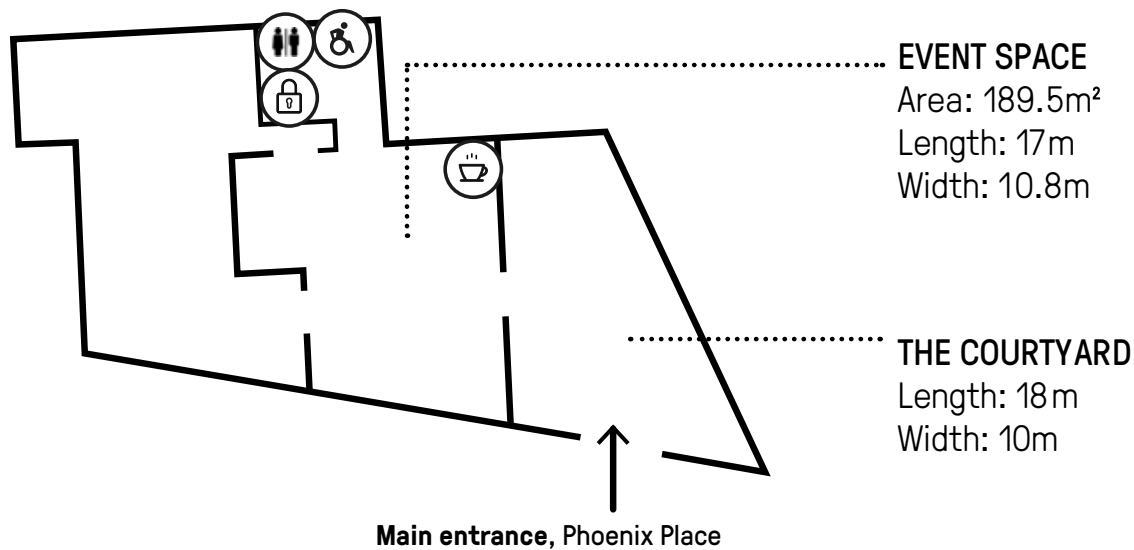

MAIL RAIL

[VIRTUAL TOUR ON OUR WEBSITE >](#)

Mail Rail is a subterranean blank canvas event space which is ideal for dinners, drinks receptions and parties through to award ceremonies, product launches and presentations.

The industrial event space features vaulted arches, original exposed brick work and inspiring Gallery space.

With a capacity of 275 standing and 150 seated, Mail Rail is available to hire 7 days a week Sunday- Thursday until 00.00 and Friday and Saturday until 01.00.

From £5,000 + VAT



MAIL RAIL

[VIRTUAL TOUR ON OUR WEBSITE >](#)

LOWER GROUND FLOOR

MAIL RAIL
EXHIBITION
SPACE
Area: 91.8m²

MAIL RAIL DEPOT
(EVENT SPACE)
Area: 239.4m²
Length: 21m
Width: 11.4m
Height: 3m (from
the lowest point)

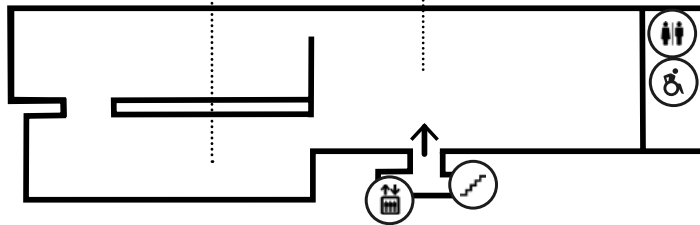

GROUND FLOOR - WELCOME SPACE

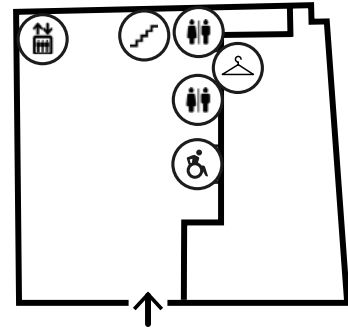

Main entrance, Phoenix Place

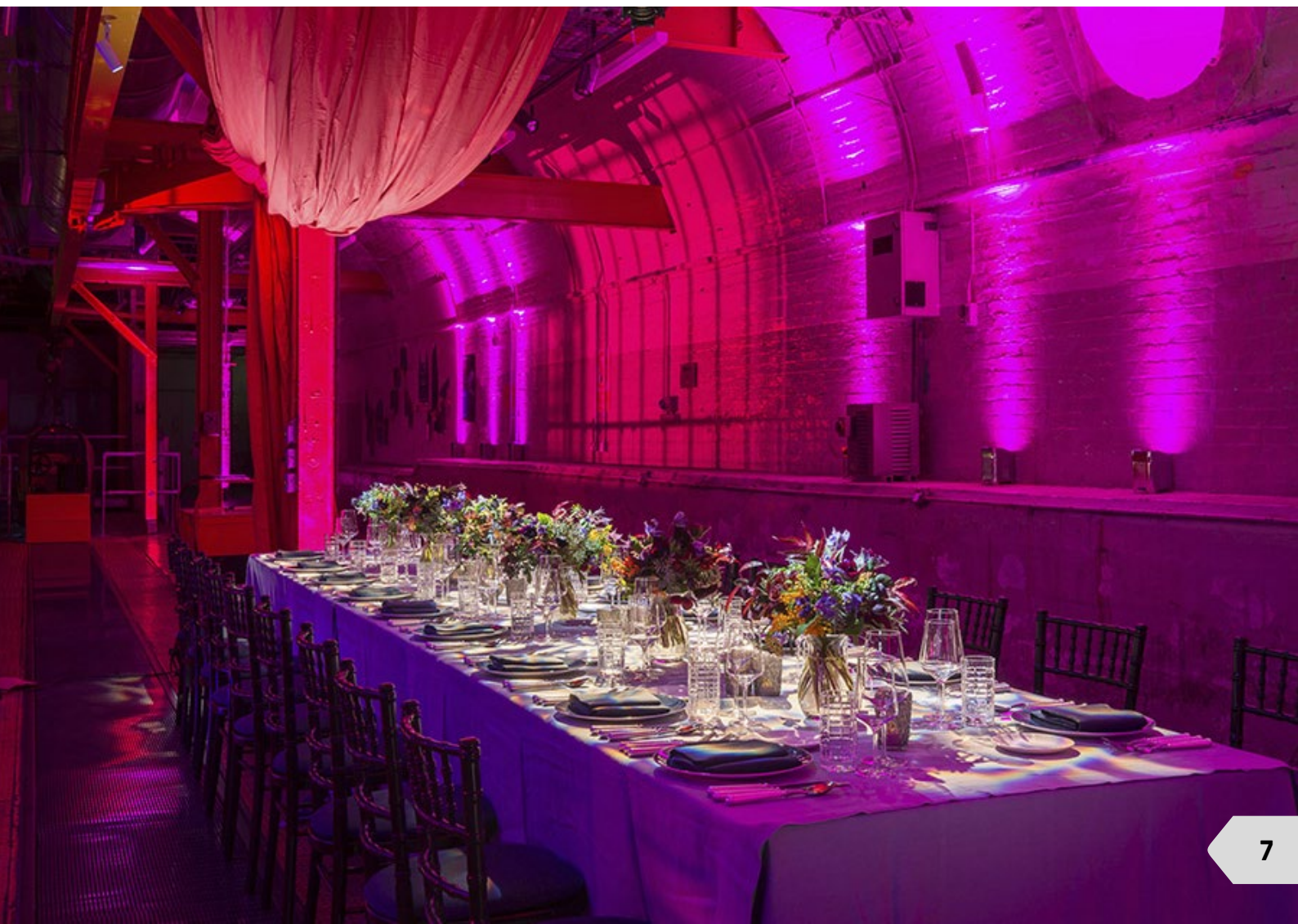

MEETING ROOM

The meeting room is a bright and clean space with views of Mount Pleasant Mail Centre. This space offers a unique meeting space with a built-in projector, great for workshops, team away days, strategy sessions and round table meetings.

Include a ride on Mail Rail or a visit to our Exhibitions for a day to remember.

From £500 + VAT



DELIVER THE UNEXPECTED

MAIL RAIL RIDE

Located deep beneath the streets of the capital is London's secret 100-year-old Post Office railway. In mid-2017, the Mail Rail tunnels opened to the public for the first time, as an immersive ride through its narrow network of hidden tunnels.

Once inside, your guests will embark on a thrilling journey 30ft underneath the streets of London. Each train can accommodate up to 20 guests with a journey time lasting 15 minutes. The trains are available to hire for up to 3 hours.

From £1,000 + VAT

PRIVATE TOURS

We offer a range of tours from special highlights, spotlight or an in-depth tour led by our expert curators. If you have a specific theme in mind, talk to our team who will be happy to tailor your tour to suit your guests' interests.

From £250 + VAT

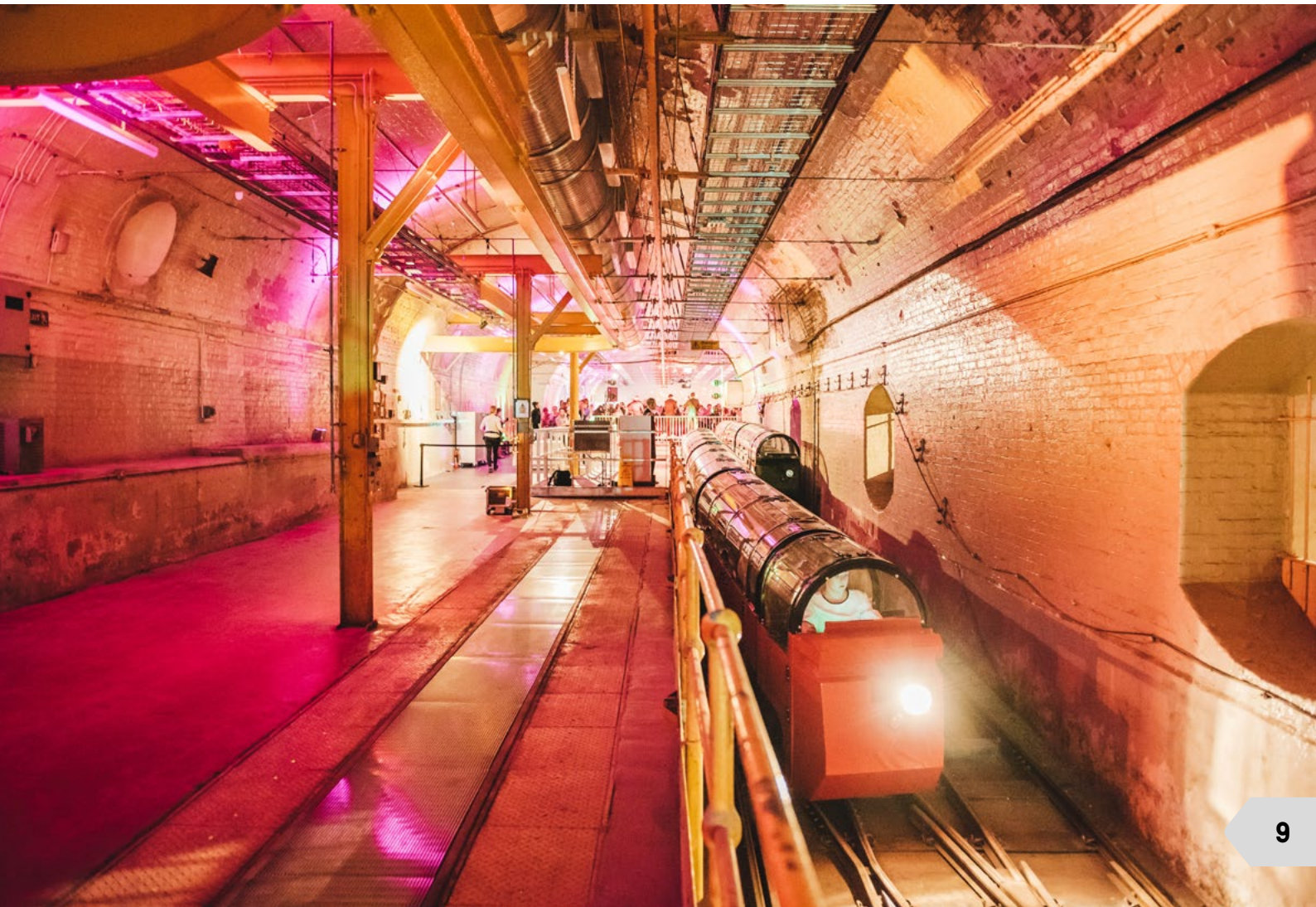

LOCATION AND CONTACT

TRAIN SERVICES:

KING'S CROSS ST. PANCRAS:

Circle, Hammersmith and City, Victoria,
Piccadilly, Metropolitan, National Rail

RUSSELL SQUARE

Piccadilly

FARRINGDON:

Circle, Hammersmith and City,
Metropolitan, National Rail

CHANCERY LANE

Central

The Postal Museum

Phoenix Place

London

WC1X 0DA

Contact us on:

venues@postalmuseum.org

postalmuseum.org/venue-hire

+44 (0)300 0300 700

